

Type 1 Type 3 Type 4

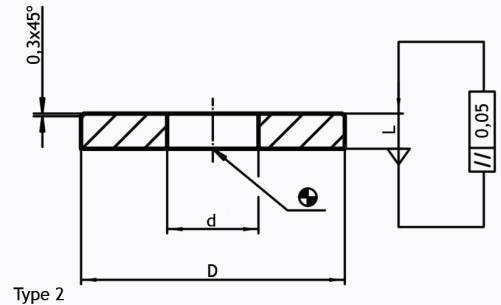

Type 2

Description

Material:

- heat-treated steel, tempered, punched, mechanically trued, phosphatized;
- heat-treated steel, tempered, blackened; stainless steel 303 (1.4305);
- steel++, hardened, ground.

Characteristics:

- type 1: Axis/C-ring DIN 6340;
- type 2: Axis/C-ring precision version;
- type 3: Axis/C-ring;
- type 4: Axis/C-ring for V40 or V70/L12 clamping system;
- type 5: Axis/C-ring for L16 clamping systems.

Technical information:

- x in the table indicates for which bolts the ring is suitable (mm);
- x1 in the table indicates for which system the ring is suitable;
- L for types 3 and 4 has a tolerance of ± 0.01 .

Article Code	d	D	L	x	x1Type	Color	Material
CI51.0329.0801	3,2	8,0	2	M3	2		Steel
CI51.0429.1201	4,2	12,0	2	M4	2		Steel
CI51.0515.1301	5,3	13,0	3	M5	2		SST
CI51.0529.1301	5,3	13,0	3	M5	2	black	Steel
CI51.0615.1701	6,4	17,0	3	M6	2		SST
CI51.0629.1700	6,4	17,0	3	M6	1	black	Steel
CI51.0629.1701	6,4	17,0	3	M6	2	black	Steel
CI51.0829.2300	8,4	23,0	4	M8	V401	black	Steel
CI51.0815.2401	8,4	24,0	4	M8	2		SST
CI51.0829.2401	8,4	24,0	4	M8	2	black	Steel
CI51.0806.2403	8,5	24,0	3		V404		Steel++
CI51.0806.3903	8,5	24,0	4		V404		Steel++
CI51.0806.2404	8,5	24,0	5		V404		Steel++
CI51.0806.3904	8,5	39,5	3		V404		Steel++
CI51.0806.2405	8,5	39,5	4		V404		Steel++
CI51.0806.3905	8,5	39,5	5		V404		Steel++
CI51.1029.2800	10,5	28,0	4	M10	V70/L121	black	Steel
CI51.1015.3001	10,5	30,0	4	M10	2		SST
CI51.1029.3001	10,5	30,0	4	M10	2	black	Steel
CI51.1229.3500	13,0	35,0	5	M12	V70/L121	black	Steel
CI51.1215.3601	13,0	36,0	5	M12	2		SST
CI51.1229.3601	13,0	36,0	5	M12	2	black	Steel
CI51.1306.3903	13,0	39,5	3		V70/L124		Steel++
CI51.1306.5903	13,0	39,5	4		V70/L124		Steel++

Article Code	d	D	L	x	x1Type	Color	Material
CI51.1306.3904	13,0	39,5	5		V70/L124		Steel++
CI51.1306.5904	13,0	39,5	10		V70/L124		Steel++
CI51.1306.3905	13,0	39,5	20		V70/L124		Steel++
CI51.1306.5905	13,0	59,5	3		V70/L124		Steel++
CI51.1306.3910	13,0	59,5	4		V70/L124		Steel++
CI51.1306.5910	13,0	59,5	5		V70/L124		Steel++
CI51.1306.3920	13,0	59,5	10		V70/L124		Steel++
CI51.1306.5920	13,0	59,5	20		V70/L124		Steel++
CI51.1429.4000	15,0	40,0	5	M14	1	black	Steel
CI51.1615.4501	17,0	45,0	5	M16	2		SST
CI51.1629.4501	17,0	45,0	5	M16	2	black	Steel
CI51.1629.4500	17,0	45,0	6	M16	V70/L121	black	Steel
CI51.1706.3903	17,5	39,5	3		L165		Steel++
CI51.1706.5903	17,5	39,5	4		L165		Steel++
CI51.1706.3904	17,5	39,5	5		L165		Steel++
CI51.1706.5904	17,5	59,5	3		L165		Steel++
CI51.1706.3905	17,5	59,5	4		L165		Steel++
CI51.1706.5905	17,5	59,5	5		L165		Steel++
CI51.1829.4500	19,0	45,0	6	M18	1	black	Steel
CI51.2029.5000	21,0	50,0	6	M20	1	black	Steel
CI51.2229.5000	23,0	50,0	8	M22	1	black	Steel
CI51.2406.5903	25,0	59,5	3		3		Steel++
CI51.2406.5904	25,0	59,5	4		3		Steel++
CI51.2406.5905	25,0	59,5	5		3		Steel++
CI51.2406.5910	25,0	59,5	10		3		Steel++
CI51.2406.5920	25,0	59,5	20		3		Steel++
CI51.2429.6000	25,0	60,0	8	M24	1	black	Steel
CI51.3029.6800	31,0	68,0	10	M30	1	black	Steel
CI51.3629.8000	38,0	80,0	12	M36	1	black	Steel

