

## maeder impact presses

Ideal for stamping small quantities or for riveting.

The mode of operation is very simple: as soon as the ram with its clamped tool reaches the workpiece, a spring is tensioned by manual force on the hand lever. At the end of the spring-tensioning stroke, the stored spring energy is then abruptly transmitted to the workpiece. The impact force of the press can be infinitely set using the star knob.

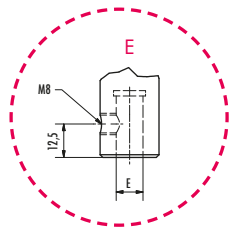
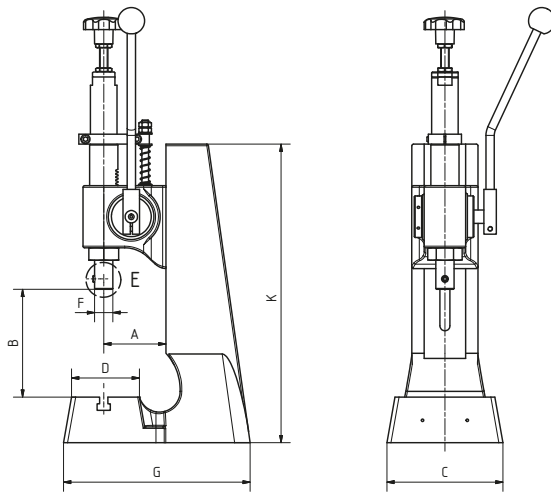

Impact press  
HP 200 FE

Type			HP 200 FE	HP 250 FE
Capacity		kN	5,5	5,5
max. working stroke		mm	60	60
Spring tensioning stroke		mm	20	20
Throat	A	mm	75	75
Daylight	B	mm	35 - 170	35 - 230
Table size	C x D	mm	80 x 120	80 x 120
Ram bore Ø x Depth	E	mm	10H7 x 25	10H7 x 25
Ram Ø	F	mm	22	22
Space requirement	C x G	mm	140 x 220	140 x 220
Daylight	K	mm	360	420
Weight		kg	ca. 20.0	ca. 20.5

Request CAD at [www.maederpressen.de](http://www.maederpressen.de) or directly from Tel.+49 (0) 74 67 - 94 67 - 0

The straightening tool can be used with any mader manual toggle press. It consists of the straightening table, which is clamped onto the press, the straightening punch, two holders for the workpiece, and the dial gauge holder with probe. A dial gauge is not part of the scope of supply, but can also be supplied.

The straightening tool consists of the following individual components:

- Measuring probe TRT 200
- Straightening blocks RB 1-200
- Pair of straightening plates RP 1-W
- Straightening table 1-200
- Straightening stamp RST-H
- Optional: dial gauges.

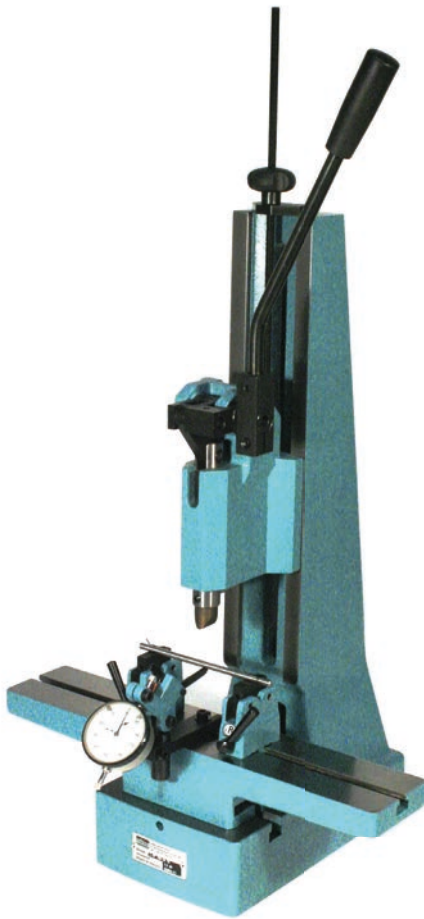

RB 1-200  
with RP 1-W



RP 1-W

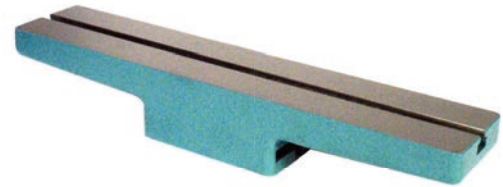

RT 1-200



RST-H



TRT 200  
with dial gauges (optional)

Model			RT 1-200	RB 1-200	RP 1-W	RST-H
Dimensions	AxB	mm	400 x 80	55 x 25		
Height		mm	60	60		
Size of straightening plate		mm		35 x 30 x 10	35 x 30 x 10	
T-slot		mm	10	10		
Spigot		mm				10h8
Weight		kg	ca. 7,5	ca. 1		

Model	TRT 200	
Dial gauge holder	mm	8H7
Measuring range	mm	5
Weight	kg	ca. 0,5